

NATURE
CREATED THE BEAUTY



WE HAVE CREATED
THE **FINEST LINED PUMPS**



...SINCE 1989

SERIES PPK

The leading manufacturer of non-metallic pumps, **Raje-Dia** now presents the PPK Series Lined pumps specially designed to handle a wide spectrum of highly corrosive media. It uses a hi-tech lining process, free from adhesive bonding. This eliminates peeling off of the lining from the metal body unlike other lined products. Rigorous quality checks through out the lining process ensures years of trouble free operation. These pumps are available in a variety of lining materials to withstand severe corrosion and temperature conditions.

FEATURES: The hi-tech lining process involves high pressure moulding at high temperature to ensure uniform thickness of lining free from cavities, air pockets, cold flows, etc. A unique feature is the **dove-tail grooves** provided on the metal casing and backplate. This ensures a firm grip between the metal and lining material. A dynamically balanced, solid moulded, semi-open impeller with metallic insert gives mechanical strength and durability.

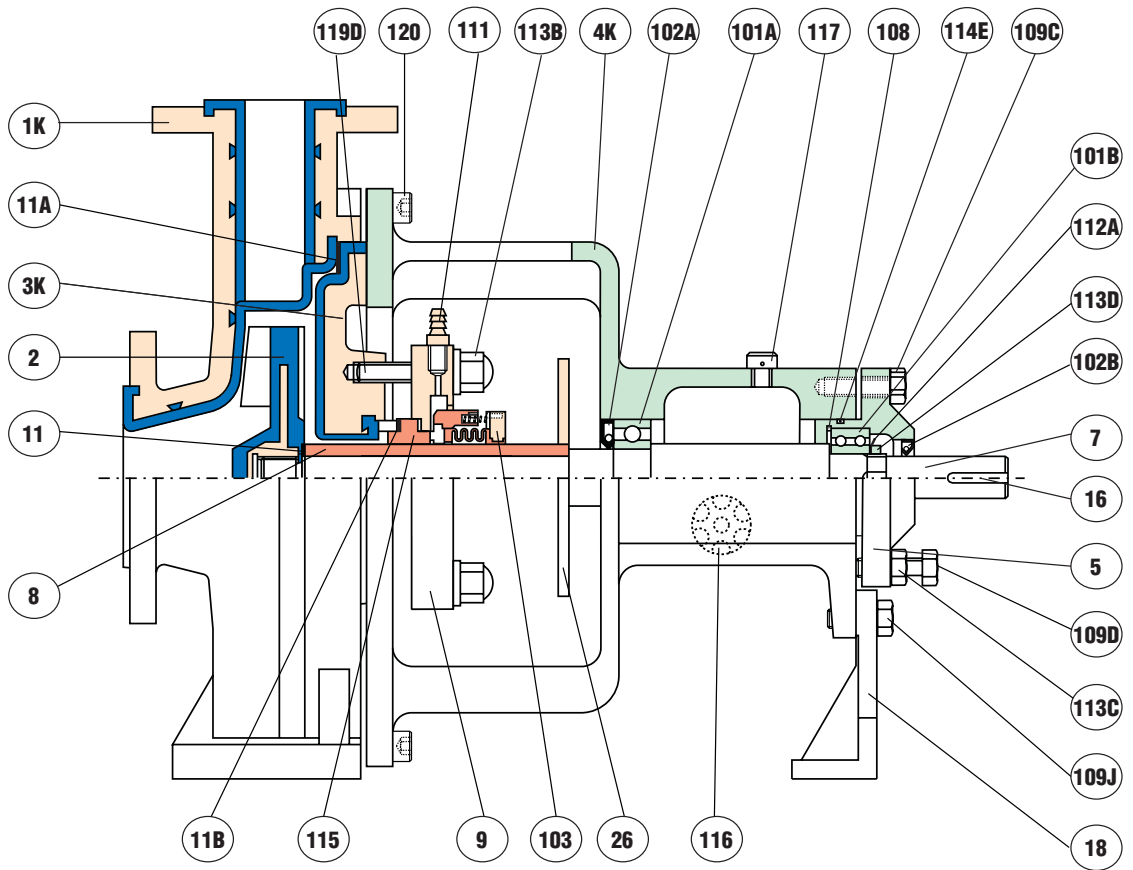
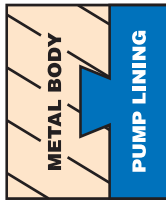

NO	PART NAME	MATERIAL	QTY	NO	PART NAME	MATERIAL	QTY	NO	PART NAME	MATERIAL	QTY
1K	CASING	*	1	18	SUPPORT PLATE	STEEL	1	112A	LOCK WASHER	STEEL	1
2	IMPELLER	*	1	26	DEFLECTOR	PP	1	113B	NUT	STEEL	
3K	BACK PLATE	*	1	101A	INBOARD BEARING	STEEL	1			WITH GRP	4
4K	BEARING FRAME	CI	1	101B	OUTBOARD BEARING	STEEL	1	113C	LOCK NUT	STEEL	3
5	BEARING CUP	CI	1	102A	INBOARD OIL SEAL	NEOPRENE	1	113D	BRG.LOCK NUT	STEEL	1
7	SHAFT	SS-316	1	102B	OUTBOARD OIL SEAL	NEOPRENE	1	114E	O RING	NEOPRENE	1
8	SLEEVE	*	1	103	MECHANICAL SEAL	*	1	115	MATING RING	*	1
9	GLAND	SS-316	1	108	CIRCLIP	STEEL	1	116	OIL LEVEL INDICATOR	ALUMINIUM	
11	GASKET	PTFE	1	109C	HEX.BOLT	STEEL	3			ALUMINIUM	1
11A	GASKET	PTFE	1	109D	HEX.BOLT	STEEL	3	117	BREATHER	STEEL	1
11B	GASKET	PTFE	1	109J	HEX.BOLT	STEEL	1	119D	STUD	STEEL	4
16	KEY	SS-316	1	111	NIPPLE	PP	2	120	ALLEN BOLT	STEEL	6/8

* varies as per requirement.

MATERIALE OF CONSTRUCTION:

The PPK Series lined pumps are available in the following materials. LINING : PFA-(Teflon), FEP-(Teflon), PVDF

CASING AND BACKPLATE : Cast Iron, Cast Steel, Stainless Steel 316. The M.O.C. is selected on the basis of the compatibility and temperature of the fluid handled as per the specific requirement. The pumps are available for high head and capacity.

SHAFT : Shafts are designed for high torque and power transmission with minimum vibration, deflection and noise level.

SLEEVE : The sleeves are glided over the shaft, protecting it from corrosive application. Materials: Ceramic, Alloy-20, Hasteloy-c, Hasteloy-B, Monel, Titanium, Silicon Carbide etc.

MECHANICAL SEALS : Available with an option of being mounted either externally or internally. The pumps are fitted with specially designed single or double seals with suitable faces alongwith quenching arrangement & necessary API Plans if required.

GASKET : To ensure firm sealing, PTFE gaskets are provided at the joints.

CASING/ BACKPLATE : The wetted areas are lined with compatible polymer. The casing has a rugged foot- mounting which is capable of handling high pressure, piping loads and system pressure. Concentric dove-tail grooves ensure a firm grip between the metal body and lining.

IMPELLER : The impeller has a radial semi- open design, with large contoured flow passages. It is one piece, of robust construction, dynamically balanced and is provided with back vanes to minimise axial thrust for enhanced bearing life.

COMPOSITE PERFORMANCE CHARACTERISTICS

2900 RPM

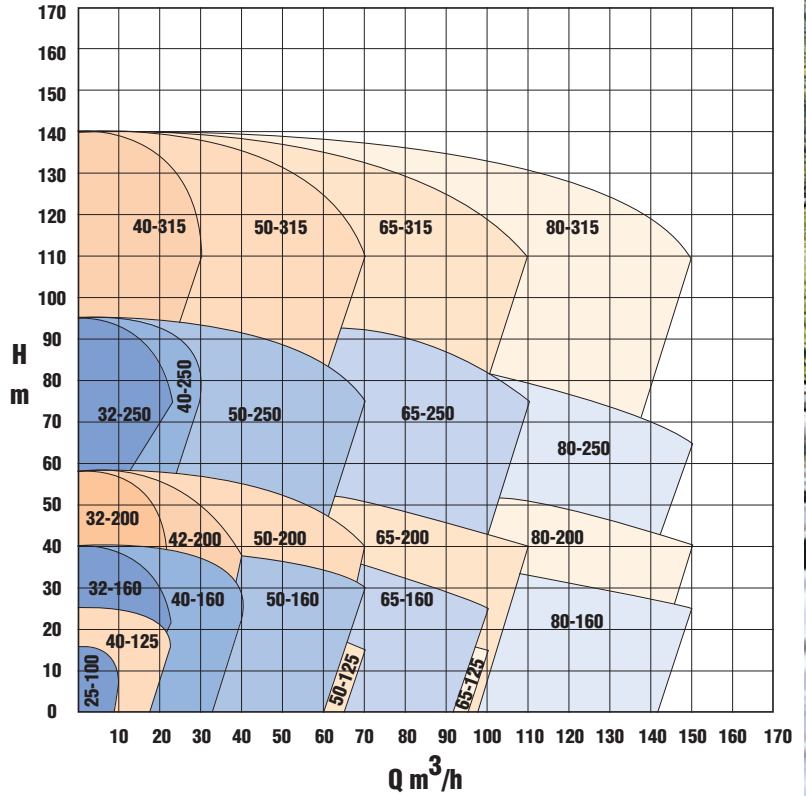

1450 RPM

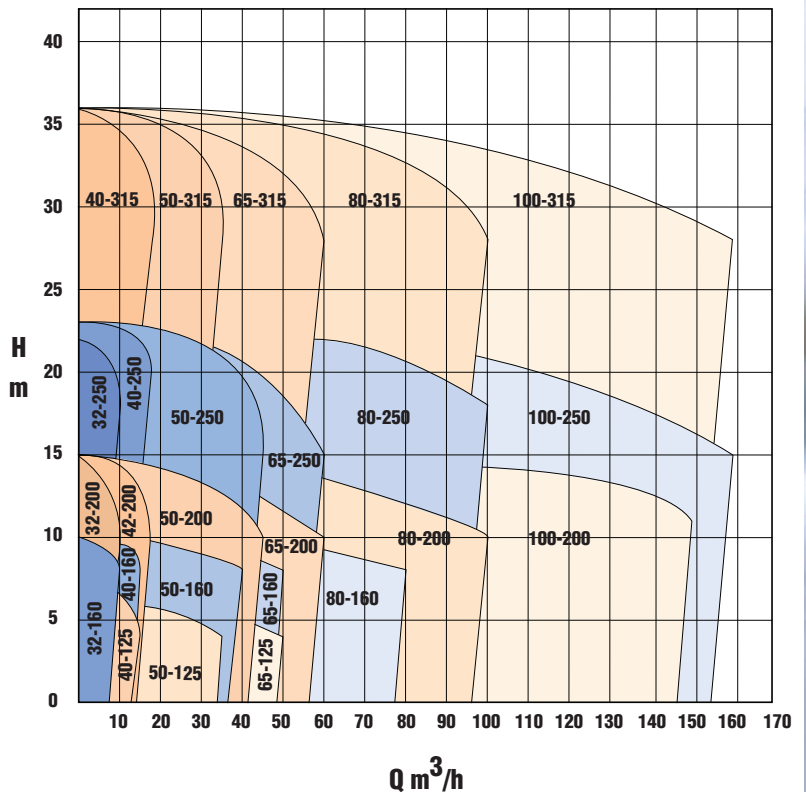

APPLICATIONS AND INDUSTRIES SERVED

- Chemical Processing
- Effluent Treatment
- Fumes scrubbing
- Acid pickling
- Recirculation process
- Photographic processing
- Drugs and Pharmaceuticals
- Food processing
- Agro chemicals
- Perfumeries
- Detergents and Caustics
- Breweries
- Petrochemicals
- Dyes and Pigments
- Tanneries
- Paper and Pulp industries



The **Raje-Dia** Group of Industries are dedicated to the manufacture of highly corrosive liquid handling systems for the core sector. An exhaustive survey was carried out on pumps built for handling corrosive liquids at high temperatures under various service conditions. To meet the growing demand, **Raje-Dia** has a fully equipped state-of-the-art manufacturing plant in Gujarat with comprehensive production, quality assurance and testing facilities.

Raje-Dia pumps are available all over the country with an efficient Dealers & aftersales service network.



...SINCE 1989

THE HI-TECH SOLUTION FOR CORROSION

Raje-Dia Pumps Pvt. Ltd.

1 - G, Laxmi Industrial Estate, New Link Road,
Andheri (West), Mumbai 400 053, INDIA.
Fax: 91-22- 2632 0866
Phone: 91-22-2635 2846, 2639 0337/38, 2636 1737
Website: www.rajediapumps.com
E-mail: rppl@rajediapumps.com



SINCE 1967
...together we achieve

: Authorised Dealer :

